

NOTE--ALL STRUCTURE IS FULLY WELDED WITH A NOMINAL FILLET RADIUS OF 5mm.
 --ALL EXTRUSIONS ARE OF GRADE 6063-T5 OR EQUIVALENT.
 --FILLER ALLOY IS OF GRADE 5356
 --DECKING IS AMPLIGRIP 201/600, EXPANDED ALUMINIUM MESH DECKING BY JURALCO.

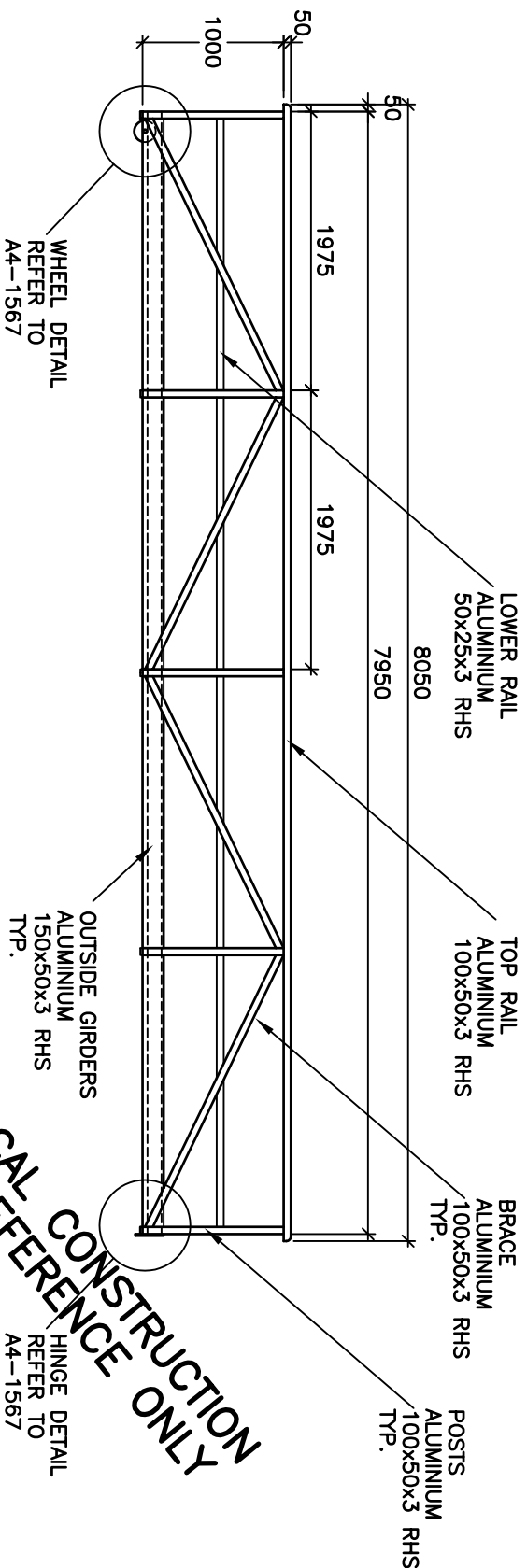

TYPICAL CONSTRUCTION FOR REFERENCE ONLY

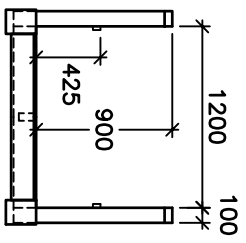

ALSO AVAILABLE WITH TIMBER DECK

APPROX. WEIGHT-290kg

DRAWING IS TO USED IN CONUNCTION WITH A4-1565, A4-1566 AND A4-1567

MARINE DOCK SYSTEMS PTY LTD

8.0m x1.2m ALUMINIUM RAMP

RAMP-1555



SCALE	N.T.S.	DRAWING No.
DRAWN	BJM	
DATE	4,6,98	REV
		A

A4-1555